

Freestanding shell scheme. Constructed in Octanorm System with Foamex infill panels. 2.5m and 2m high overall with 300mm deep fascia. See separate drawing for each stand detail.

Recital area poster boards 1m wide by 2m high.

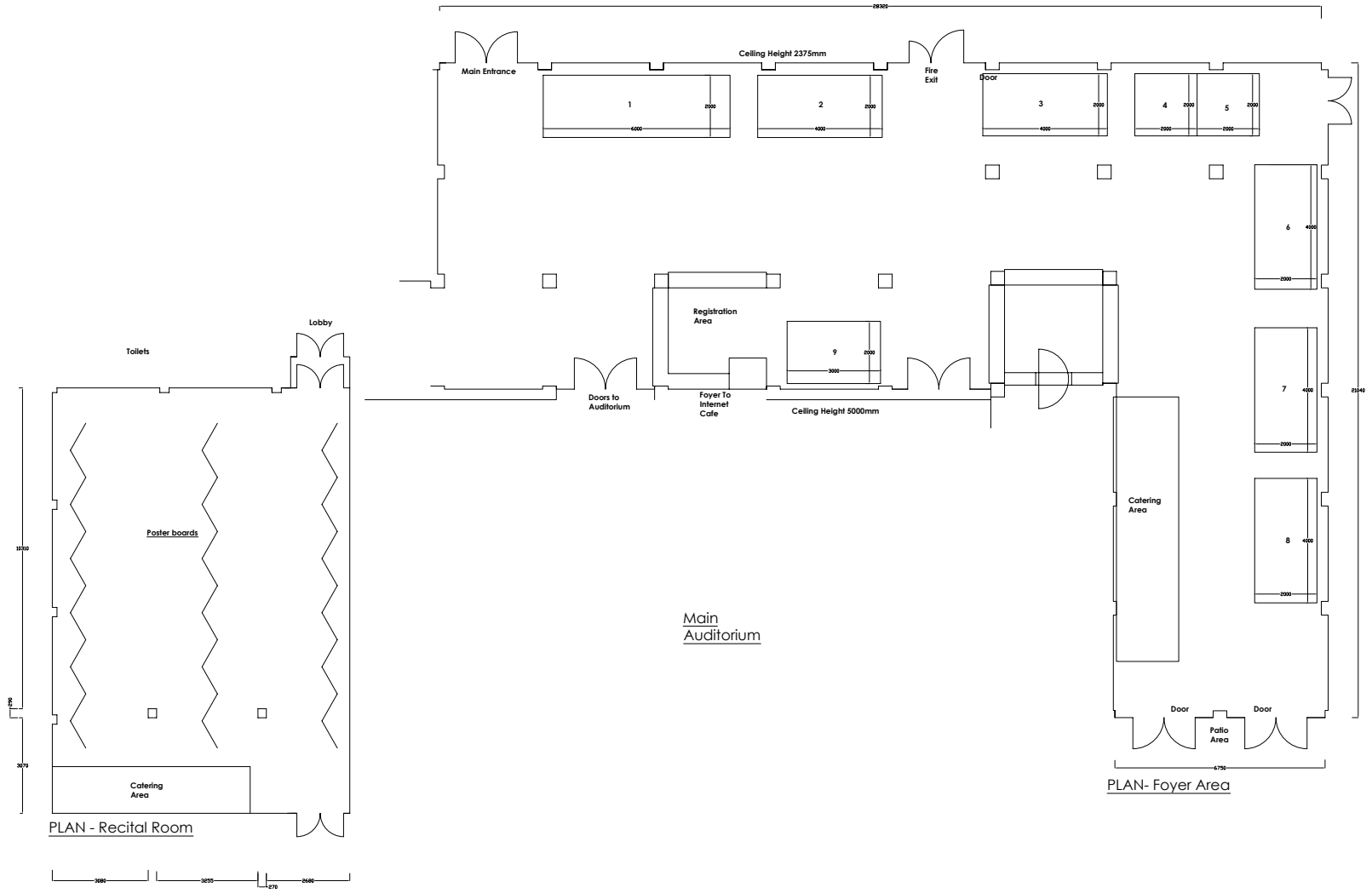

NOTES

1. COPYRIGHT OF THE DESIGN CONCEPT REMAINS THE SOLE PROPERTY OF "KORTEN LTD". THE DESIGNS PREPARED BY "KORTEN LTD" ARE DONE IN GOOD FAITH AND WILL NOT BE REPRODUCED IN ANYWAY SHAPE OR FORM WITHOUT WRITTEN AUTHORITY FROM "KORTEN LTD".
2. ALL DIMENSIONS MUST BE CHECKED ON SITE AND NOT SCALED FROM THIS DRAWING.
3. ALL MATERIALS, FIXTURES AND FINISHES CONFORM WITH CURRENT REGULATIONS REGARDING FIRE RESISTANCE AND SURFACE SPREAD OF FLAME.
4. THESE DRAWINGS ARE TO BE READ IN CONJUNCTION WITH GENERAL ARRANGEMENTS, ELEVATIONS AND SPECIFICATIONS.
5. ANY DISCREPANCIES DISCOVERED SHOULD BE REPORTED IMMEDIATELY TO "KORTEN LTD".
6. ANY ELECTRICAL WORK TO COMPLY WITH ORGANISERS REGULATIONS.
7. ALL SERVICE REQUIREMENTS/POSITIONING TO BE ADVISED BY CLIENT.
8. CONTRACTOR / STRUCTURAL ENGINEER TO ADVISE OF ANY ADDITIONAL BRACING REQUIRED.
9. ALL WORKS TO COMPLY WITH CURRENT COPY OF ORGANISERS REGULATIONS, RELEVANT CODES OF PRACTICE AND BRITISH STANDARDS.

**KORTEN**  
Korten Ltd Exhibition Design & Production  
Unit 6, Harding Way, Somersham Road,  
St Ives, England  
PE27 3WR  
Tel: +44 (0)1480 409200  
Fax: +44 (0)1480 409219  
www.korten.co.uk

**CLIENT**  
Oxford International

**PROJECT TITLE**  
2009 West Road  
Concert Hall,  
Cambridge, Foyer  
and Recital Room

**DRAWING TITLE**  
Plan

**DRAWING ALLOCATION**

<input type="checkbox"/> Client	<input type="checkbox"/> Workshop
<input type="checkbox"/> Organiser	<input type="checkbox"/> Finishing Dept
<input type="checkbox"/> Office	<input type="checkbox"/> Electrical Dept
<input type="checkbox"/> Graphics Dept	<input type="checkbox"/> Other

<b>SCALE</b>	1:75	<b>DRAWN</b>	AT
<b>Start Date</b>	08-09-08	<b>Revision Date</b>	13-10-08

**DRAWING No.**  
1630-09-08/01B

**Job No.**  
10